

THE FRIDAY FLIER

(Published fortnightly)

KOTAHITANGA

Waikato Waldorf School, Kindergartens and Play Circle



No: 06

5 May 2023

Kia ora e te whānau,

Hello everyone,

I hope you are all doing well.

It feels like we have only been back at school for two minutes and yet we find ourselves at the end of Week 2. Autumn is well and truly in full swing now. As I look out of my open window I see leaves flying and trees dancing wildly in the winds. The sounds of merry stomps carry to the office from the hall where Class One are in the midst of a joyful lesson. It's all go out there! In a month's time we will be at the start of Winter. Where, oh where, does the time go?

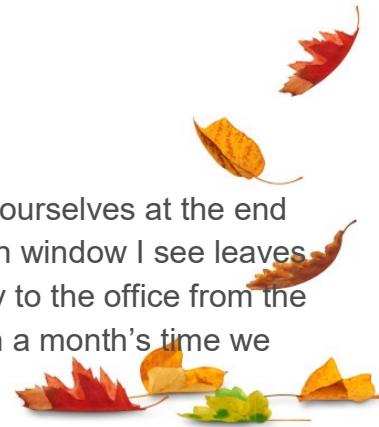

Term 2 is set to be another action packed couple of months here at school, with several special events, not least of all the Winter Matariki Festival on June 21st. In addition, Class Four have their Noho Marae trip at Hukanui Marae, Class Seven will be visiting the Auckland Writer's Festival and towards the end of the term the students in Classes Four to Seven will have the opportunity to take part in the tremendous mudfest that is the Tough Guy/Gal challenge at Ngāruawāhia. I am once again reminded that I would have loved to have gone to this school!

On Tuesday evening we held our 'Journey Through the School' event. We took 45 visitors through the school, around 80% of whom were new to our community. I am fairly certain that this is the most visitors we have ever had attend a 'Journey,' and it is incredibly exciting to see the extent to which interest is growing in a Waikato Waldorf Education and its community.

This is not only down to the existing staff, students and parent community, but also those who have gone before and enabled this school to be in the place it is today. I would like to take a moment to acknowledge all who have been involved in the journey of Waikato Waldorf Education from the beginnings back in 1982 at Olive House Kindergarten in Hamilton East, to the start of the school on this site in 1996, right through to the current day.

Kia pai tō rā whakatā koutou, have a great weekend everyone,

Rob

UPCOMING EVENTS

16th May	–	Class 7	Auckland Writer's Festival trip
18th May	–	CI4	Noho Marae trip
2nd June	–	Teacher Only Day	School closed
5th June	–	King's Birthday	School closed
20th June	–	Class 4-Class 7	Tough Guy/Gal Challenge
21st June	–	Winter Matariki Festival @5.30pm	
22nd June	–	backup date for the above	
29th June	–	Last day of term	

TERM Dates 2023

	Start Date	End Date	Breaks/Public holidays
TERM 1	31 January 2023	6 April 2023	6 February Waitangi Day
	Class 1 1 February 2023		27 March TOD after Carnival
TERM 2	27 April 2023	30 June 2023	2 June TOD
			5 June King's Birthday
TERM 3	17 July 2023	21 September 2023	
TERM 4	9 October 2023	15 December 2023	23 October Labour Day
			20 November TOD

AMAZING Blackboard drawings! Can you guess which goes with which class?

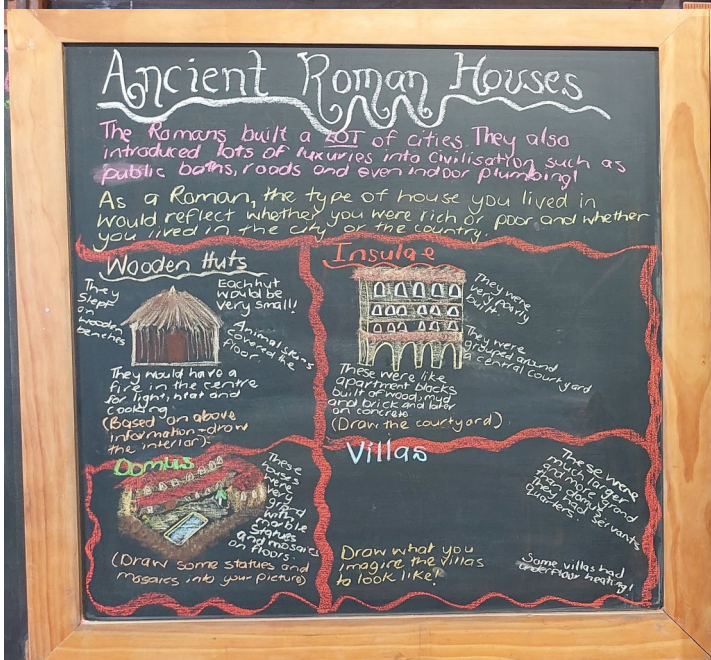
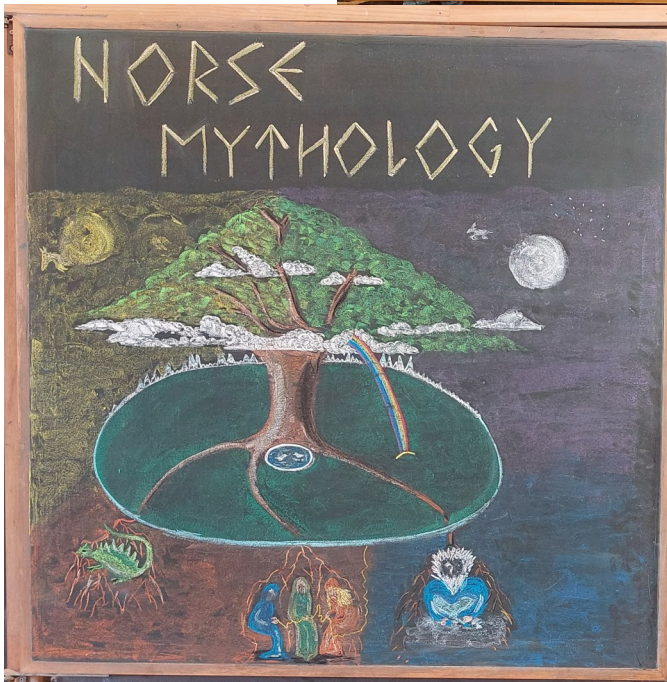

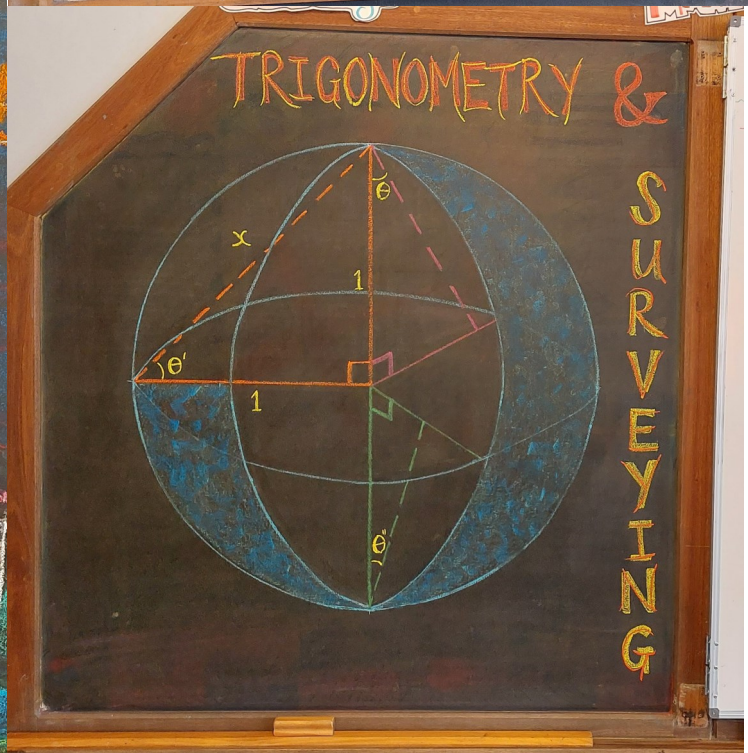
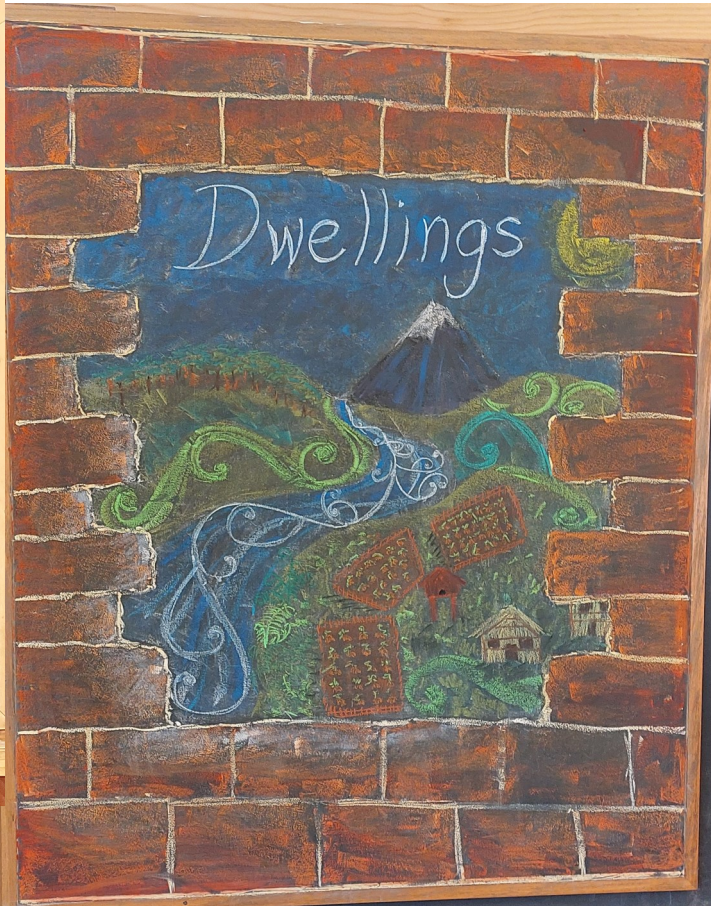

Princess Te Puea was King
 Tāwhiao's moko.
 She was a courageous leader
 protecting people from war.
 She helped to build Tūrangawaewae.

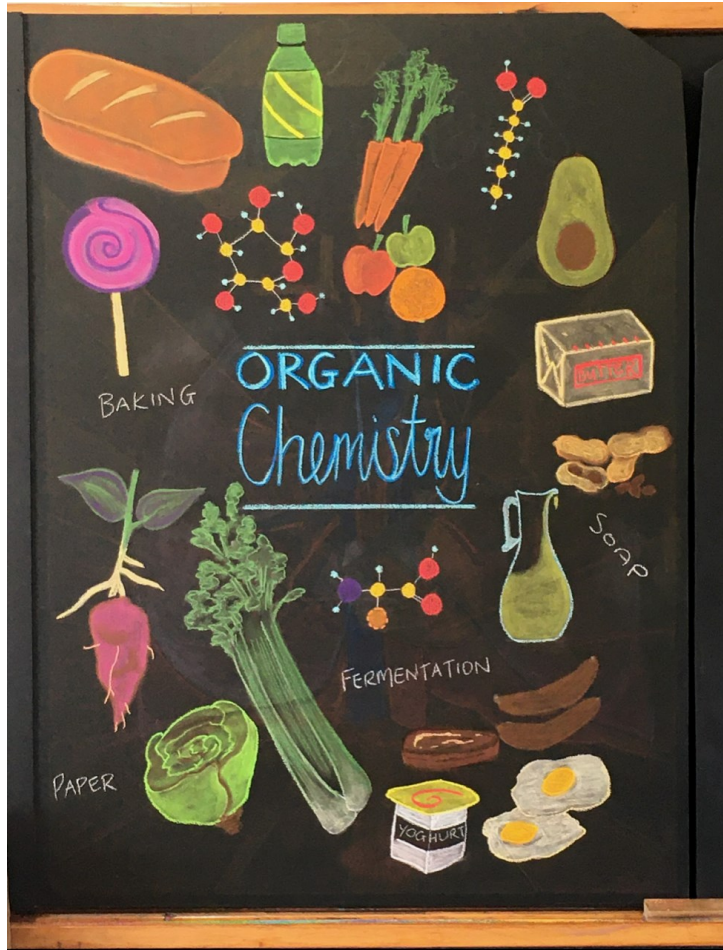

Clothing Swap

When: Thursday 18th May from 2:30pm

Where: School Circle Court

How it works: Bring any good condition clothes, you would like to donate, to the school or kindy office between now and Wednesday 17th of May.

We will sort through and organise the clothes. On Thursday 18th of May from 2:30pm, come to the circle court at school and help yourself to any clothes that take your fancy.

No money needed.

Any clothes leftover will then be donated to the op shops.

We are looking for helpers to sort, set up and pack down.

If this is you, please let Jo 021774110
or Kylee 0220623707 know



SCHOOL DEVELOPMENT PROJECT UPDATE

We will be giving you regular updates with our progress in establishing our two new lower school classrooms and the science laboratory.

We now have a draft design plan for the science laboratory. A few tweaks are still needed but we are on our way.

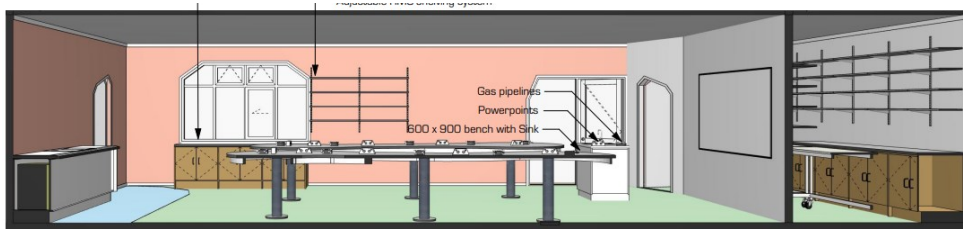
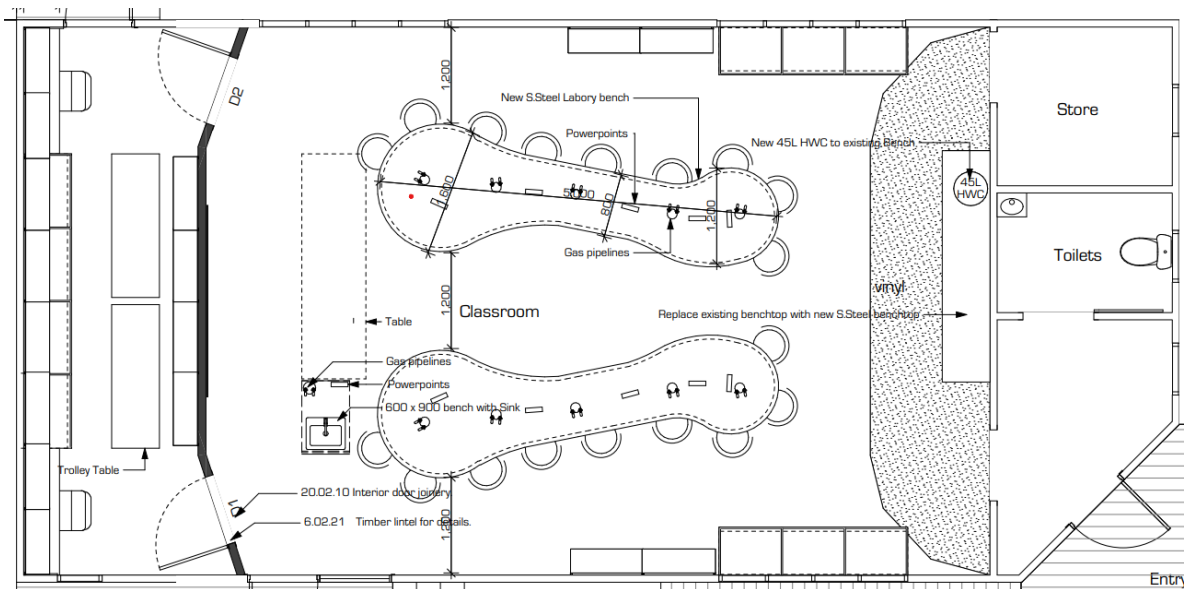

Very shortly we will be able to show you the concept plan for our new Class 1 and 2 classrooms.

In the meantime, a great piece of news!

We have been donated a massive \$50,000 from a generous contributor towards our development costs and we have now launched our Givealittle page.

Whilst our ultimate long-term target for fundraising is \$500,000 this encompasses all the different individual projects along the way and spans a number of years as we build and renovate existing buildings and landscape and beautify the outside areas.

So if you are able to contribute on our Givealittle page and share it with others that would be fantastic.

All funds are gratefully received as we continue our journey.

<https://givealittle.co.nz/cause/waikato-waldorf-school-development-project>

COMMUNITY NOTICES

These notices are published as a service to the school community. Publication is at the discretion of the Editor, and does not necessarily reflect the opinion of the Faculty.



GIRL POWA
Adult & Teen Adventure Day
Mother/Daughter Aunt/Niece Big Sister/Little Sister

Adventure Together
Lead, inspire, support, laugh, bond, learn, challenge

GIRL POWA
ADVENTURE DAY

SATURDAY 20TH MAY 2023
8.30AM - 4.30PM
PIRONGIA FOREST PARK LODGE

\$100 PER TEAM: FEMALES ONLY
1 ADULT AND 1 TEEN PER TEAM
includes 4 activities, morning & afternoon tea and lunch

Call 021 118 7771 admin@firststepoutdoors.com www.firststepoutdoors.com

ACTIVITIES

- Zip Line
- Climbing
- Abseiling
- Archery

BOOK NOW

First Step Outdoors
Tū Manawa Active Aotearoa



TARUNA COLLEGE
Connect, Nourish, Sustain

Art of Well-Being
Staying Upright, Keeping Heart

Perhaps now more than ever, our sense of 'well-being' is being deeply challenged. We need fresh tools and understandings that develop skills, strategies and capacities for inner certainty and resilience. Here at Taruna we define well-being as a sense of being fully available to life – drawing from the well-spring that lets us best connect and sustain the relationships we have with ourselves, as well as with the people and the work that matter to us. A theme of the **Art of Well-Being** is 'staying upright, keeping heart' - wakeful approaches that actively bring us back to centre when we are pushed or pulled from being upright. In the programme we open up simple daily practices such as journaling, observation, the use of poetry, verses and meditations, engaging in art, doing eurythmy, appreciating art, having good conversations, and practising simple home nursing treatments. All develop our heart connection, our artfulness and our discernment.

The **Art of Well-Being** invites you to three five-day seminars over 2023. The programme is gentle yet enquiring, focusing on three themes that renew our well-being:

- Art** - recognising art as the language of the soul we progressively work with colour, form, line, movement and language to deepen our ways of connecting and expressing our rich world within.
- Life-story work** - discovering the meaning and potential in our biographies, as we explore windows into our own life stories and the rich tapestries that each of our lives have woven.
- Contemporary, holistic thinking** - which explores the world and our humanity in fresh ways. In particular we draw on contemporary applications of the work and understandings of Anthroposophy inspired by Rudolf Steiner.

The **Art of Well-Being** dates for 2023:
Seminar One: Tuesday (pm) 16 May - Sunday (am) 21 May
Seminar Two: Tuesday (pm) 15 August - Sunday (am) 20 August
Seminar Three: Tuesday (pm) 31 Oct - Sunday (am) 5 November

The **Art of Well-Being** is designed for:

- busy professionals looking for renewal and nourishment so they can be creative in the workplace
- those connected to Steiner/ Waldorf schools looking to renew and deepen their connection
- those working in education or health needing fresh tools and approaches to revitalise their work
- those at a crossroads who need time to take stock and consider the road ahead
- those who wish to honour the dimension of spirit in their lives.

Cost: \$1100 per seminar (**Early bird price** of \$1000 per seminar when all three seminars are paid on enrolment at least one month prior to Seminar One). **Come with a friend and both get a 10% discount.** Minimum numbers are required for the course to begin.

Art of Well-Being Team:
Lauren Hudson, Rosie Simpson, and Deb Bednarek.

The Crystal Bridge Foundation makes interest-free loans available to funded students. For more information, see our website www.taruna.ac.nz or inquire in person on 06 4771734 or info@taruna.ac.nz

Saturday morning music classes

Enrolments are now open for Term Two 2023 at the Waikato Community School of Music. The first session is on Saturday 29th April. The school caters for all ages (3 to retired) and ability levels, offering group-format and one-to-one music tuition in a range of instruments. Group-format class fees range from \$45 to \$110 per term (8 lessons in Term Two) depending on student age and the instrument chosen. The enrolment fee for an instrument class includes participation in as many of our ensembles as the student wishes. Enrolment in ensembles only is also an option. One-to-one classes can aid in preparing for exams and earning NCEA credits.

Class times are between 8:00am and 2:00pm on Saturdays during primary school terms. WCSM is located on the University of Waikato campus in Hillcrest.

Contact us via our website [WCSM](http://www.wcsm.ac.nz) or on 07 838 4611. www.wcsm.ac.nz +64 (0)22 636 8194

85 Barrington Drive, Huntington, Hamilton
 Ph: 07 855 8710 email: office@waikatowaldorf.school.nz
 website: www.waikatowaldorf.school.nz [www.facebook.com/WaikatoWaldorf School](https://www.facebook.com/WaikatoWaldorfSchool)